

SHOOTING BOARD

SIDE VIEW

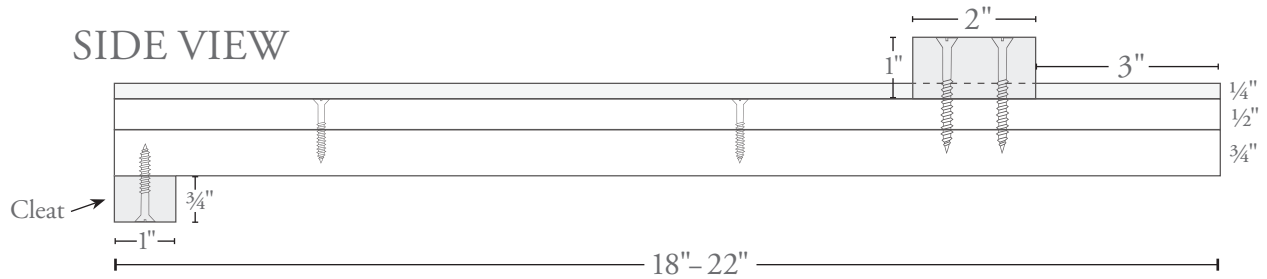

TOP VIEW

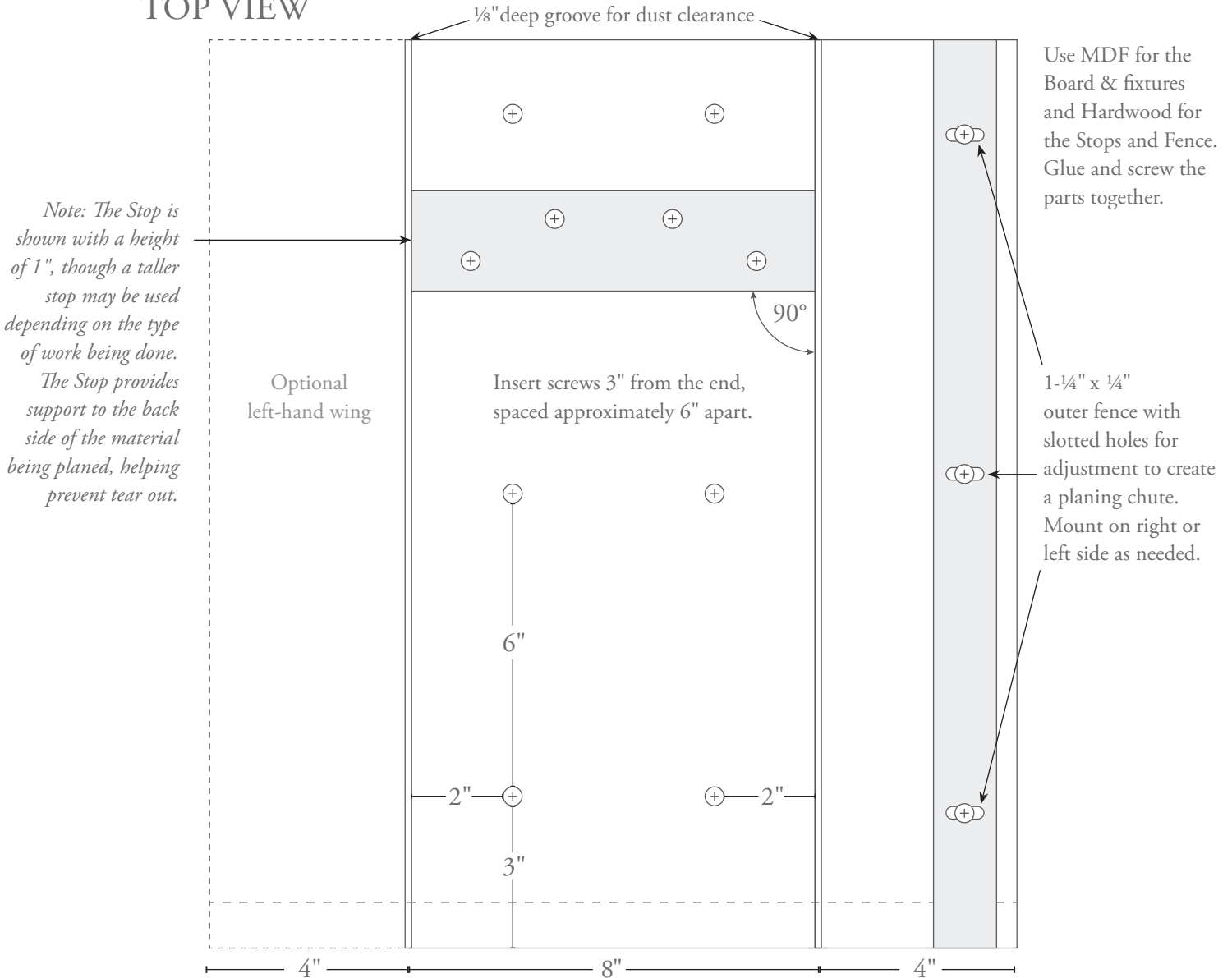

END VIEW

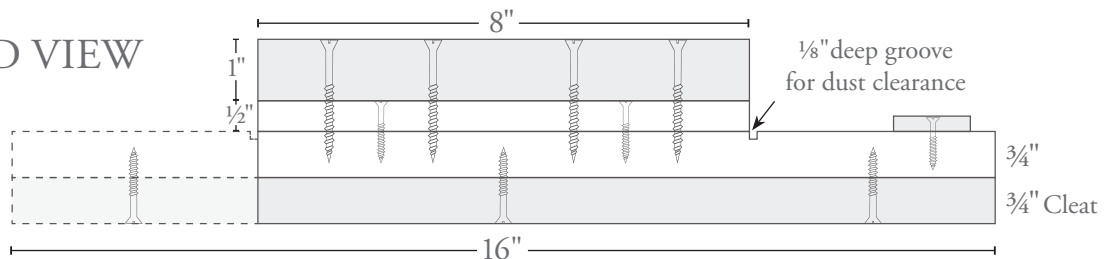

SHOOTING BOARD FIXTURES

45° MITER FIXTURE

Made from MDF

Glue $\frac{3}{8}$ " wooden dowels into the underside of the fixtures and drill a matching set of $\frac{3}{8}$ " holes into the shooting board's top layer of $\frac{1}{2}$ " MDF to easily align and secure the fixtures.

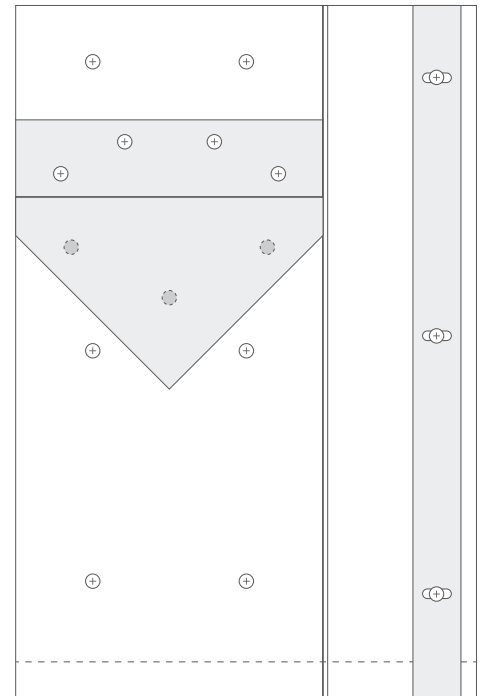
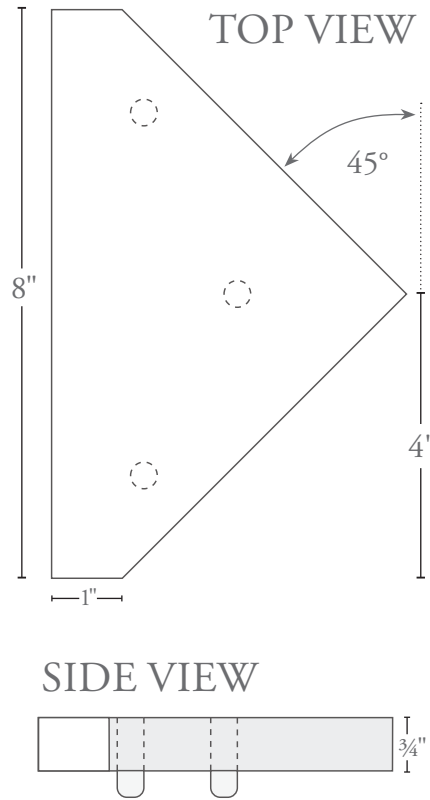

Installed in the Shooting Board

45° MITER "BIRD HOUSE" FIXTURE

Made from MDF and Hardwood

SIDE VIEW

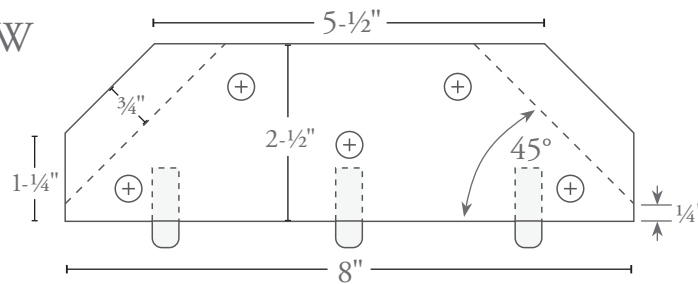

TOP VIEW

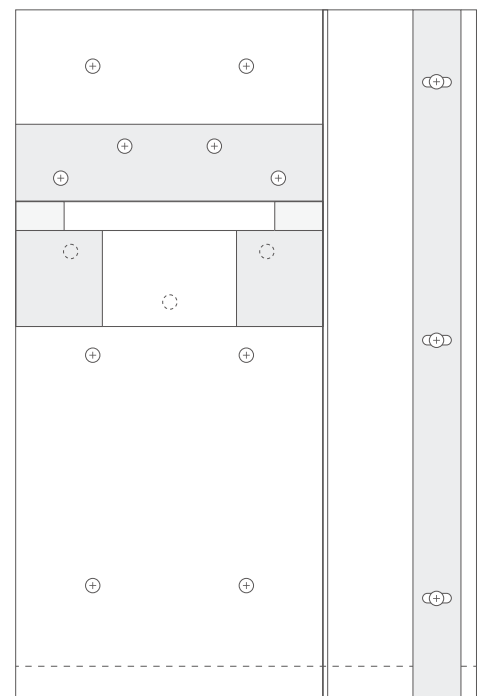
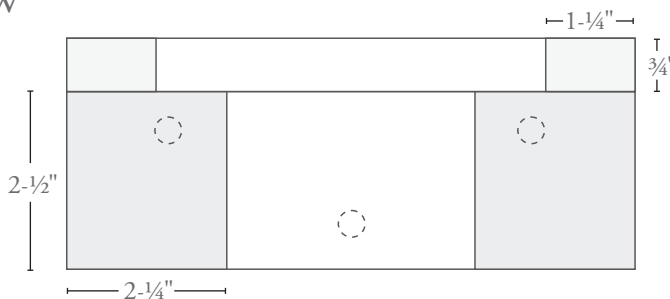

Installed in the Shooting Board